



Report of: **Service Director, Public Protection**

Meeting of	Date	Agenda Item	Ward(s)
Licensing Sub-Committee	8 th December 2015		Clerkenwell

Delete as appropriate		Non-exempt
-----------------------	--	------------

Subject: PREMISES LICENCE NEW APPLICATION
City News, 4 Exmouth Market, London EC1R 4PX

1. Synopsis

- 1.1 This is an application for a new premise licence under the Licensing Act 2003.
- 1.2 The application is to allow:
 - a) The sale of alcohol, for consumption off the premises, between: 09:00 and 21:00, Monday to Sunday. The applicants have subsequently agreed with the Metropolitan Police to amend the proposed start time on Sundays to 10:00am.
 - b) Opening hours between: 07:00 and 21:00, Monday to Sunday.

2. Relevant Representations

Licensing Authority	Yes
Metropolitan Police	No
Noise	No
Health and Safety	No
Trading Standards	No

Public Health	No
Safeguarding Children	No
London Fire Brigade	No
Local residents	No
Other bodies	No

3. Background

3.1 Papers are attached as follows:-

Appendix 1: application form and applicant's response to representations;

Appendix 2: representations;

Appendix 3: suggested conditions and map of premises location.

3.2 Representations from the Metropolitan Police, Trading Standards and Noise Service have been withdrawn on the basis that licence conditions have been agreed.

4. Planning Implications

4.1 The application is for a premises licence for a shop, falling under use class A1. This is the lawful use of the site and there are no ongoing enforcement investigations concerning the land. As such, the planning department has no objections to the application.

5 Recommendations

5.1 To determine the application for a new premises licence under Section 17 of the Licensing Act 2003.

5.2 To consider that this address is in the Saturation or "Cumulative Impact Policy" of Islington. This special policy creates a rebuttable presumption that applications for new premises licences, club premises certificates, or variation applications that are likely to add to the existing cumulative impact will normally be refused, unless the applicant can demonstrate why the operation of the premises involved will not add to the cumulative impact or otherwise impact adversely on the promotion of the licensing objectives.

5.3 If the Committee grants the application it should be subject to:

- i. conditions prepared by the Licensing Officer which are consistent with the Operating Schedule (see appendix 3)
- ii. any conditions deemed appropriate by the Committee to promote the four licensing objectives.(see appendix 3)

6 Conclusion and reasons for recommendations

- 6.1 The Council is required to consider this application in the light of all relevant information, and if approval is given, it may attach such conditions as appropriate to promote the licensing objectives.

Background papers:

The Council's Statement of Licensig Policy
Licensing Act 2003
Secretary of States Guidance

Final Report Clearance

Signed by

Service Director – Public Protection

25.11.15
Date

Received by

Head of Scrutiny and Democratic Services

Date

Report author: Licensing Service

Tel: 020 75027 3031

E-mail: licensing@islington.gov.uk

* required information

Section 1 of 19

You can save the form at any time and resume it later. You do not need to be logged in when you resume.

System reference

Not Currently In Use

This is the unique reference for this application generated by the system.

Your reference

islington-city news

You can put what you want here to help you track applications if you make lots of them. It is passed to the authority.

Are you an agent acting on behalf of the applicant?

- Yes No

Put "no" if you are applying on your own behalf or on behalf of a business you own or work for.

Applicant Details

* First name

HARSHA

* Family name

RAJA

* E-mail

[REDACTED]

Main telephone number

Include country code.

Other telephone number

Indicate here if the applicant would prefer not to be contacted by telephone

Is the applicant:

- Applying as a business or organisation, including as a sole trader
 Applying as an individual

A sole trader is a business owned by one person without any special legal structure. Applying as an individual means the applicant is applying so the applicant can be employed, or for some other personal reason, such as following a hobby.

Continued from previous page...

Address

* Building number or name	<input type="text"/>
* Street	<input type="text"/>
District	<input type="text"/>
* City or town	<input type="text"/>
County or administrative area	<input type="text"/>
* Postcode	<input type="text"/>
* Country	<input type="text" value="United Kingdom"/>

Agent Details

* First name	<input type="text" value="ROBERT"/>
* Family name	<input type="text" value="JORDAN"/>
* E-mail	<input type="text" value="robertjordan01@btinternet.com"/>
Main telephone number	<input type="text" value="01279 850753"/>
Other telephone number	<input type="text"/>

Include country code.

Indicate here if you would prefer not to be contacted by telephone

Are you:

- An agent that is a business or organisation, including a sole trader
 A private individual acting as an agent

A sole trader is a business owned by one person without any special legal structure.

Agent Business

* Is your business registered in the UK with Companies House?	<input checked="" type="radio"/> Yes <input type="radio"/> No
* Registration number	<input type="text" value="5449933"/>
* Business name	<input type="text" value="PR RETAIL CONSULTANTS"/>
* VAT number	<input type="text" value="-"/> <input type="text" value="NONE"/>
* Legal status	<input type="text" value="Private Limited Company"/>
* Your position in the business	<input type="text" value="DIRECTOR"/>
Home country	<input type="text" value="United Kingdom"/>

If your business is registered, use its registered name.

Put "none" if you are not registered for VAT.

The country where the headquarters of your business is located.

Continued from previous page...

Agent Registered Address

Address registered with Companies House.

* Building number or name	PUMP HOUSE
* Street	OLD MEAD ROAD
District	HENHAM
* City or town	BISHOP'S STORTFORD
County or administrative area	HERTS
* Postcode	CM22 6JG
* Country	United Kingdom

Section 2 of 19

PREMISES DETAILS

I/we, as named in section 1, apply for a premises licence under section 17 of the Licensing Act 2003 for the premises described in section 2 below (the premises) and I/we are making this application to you as the relevant licensing authority in accordance with section 12 of the Licensing Act 2003.

Premises Address

Are you able to provide a postal address, OS map reference or description of the premises?

Address OS map reference Description

Postal Address Of Premises

Building number or name	CITY NEWS, 4
Street	EXMOUTH MARKET
District	
City or town	LONDON
County or administrative area	
Postcode	EC1R 4PX
Country	United Kingdom

Further Details

Telephone number	
Non-domestic rateable value of premises (£)	15,250

Section 3 of 19

APPLICATION DETAILS

In what capacity are you applying for the premises licence?

- An individual or individuals
- A limited company
- A partnership
- An unincorporated association
- A recognised club
- A charity
- The proprietor of an educational establishment
- A health service body
- A person who is registered under part 2 of the Care Standards Act 2000 (c14) in respect of an independent hospital in Wales
- A person who is registered under Chapter 2 of Part 1 of the Health and Social Care Act 2008 in respect of the carrying on of a regulated activity (within the meaning of that Part) in an independent hospital in England
- The chief officer of police of a police force in England and Wales
- Other (for example a statutory corporation)

Confirm The Following

- I am carrying on or proposing to carry on a business which involves the use of the premises for licensable activities
- I am making the application pursuant to a statutory function
- I am making the application pursuant to a function discharged by virtue of Her Majesty's prerogative

Section 4 of 19

INDIVIDUAL APPLICANT DETAILS

Applicant Name

Is the name the same as (or similar to) the details given in section one?

- Yes No

If "Yes" is selected you can re-use the details from section one, or amend them as required. Select "No" to enter a completely new set of details.

First name

Family name

Is the applicant 18 years of age or older?

- Yes No

Continued from previous page...

Applicant Postal Address

Is the address the same as (or similar to) the address given in section one?

Yes No

If "Yes" is selected you can re-use the details from section one, or amend them as required. Select "No" to enter a completely new set of details.

Building number or name	<input type="text"/>
Street	<input type="text"/>
District	<input type="text"/>
City or town	<input type="text"/>
County or administrative area	<input type="text"/>
Postcode	<input type="text"/>
Country	<input type="text" value="United Kingdom"/>

Applicant Contact Details

Are the contact details the same as (or similar to) those given in section one?

Yes No

If "Yes" is selected you can re-use the details from section one, or amend them as required. Select "No" to enter a completely new set of details.

E-mail	<input type="text"/>
Telephone number	<input type="text"/>
Other telephone number	<input type="text"/>

Add another applicant

Section 5 of 19

OPERATING SCHEDULE

When do you want the premises licence to start?

<input type="text" value="19"/>	/	<input type="text" value="11"/>	/	<input type="text" value="2015"/>
dd		mm		yyyy

If you wish the licence to be valid only for a limited period, when do you want it to end

<input type="text"/>	/	<input type="text"/>	/	<input type="text"/>
dd		mm		yyyy

Provide a general description of the premises

For example the type of premises, its general situation and layout and any other information which could be relevant to the licensing objectives. Where your application includes off-supplies of alcohol and you intend to provide a place for consumption of these off-supplies you must include a description of where the place will be and its proximity to the premises.

CONVENIENCE STORE

Continued from previous page...

If 5,000 or more people are expected to attend the premises at any one time, state the number expected to attend

Section 6 of 19

PROVISION OF PLAYS

Will you be providing plays?

- Yes No

Section 7 of 19

PROVISION OF FILMS

Will you be providing films?

- Yes No

Section 8 of 19

PROVISION OF INDOOR SPORTING EVENTS

Will you be providing indoor sporting events?

- Yes No

Section 9 of 19

PROVISION OF BOXING OR WRESTLING ENTERTAINMENTS

Will you be providing boxing or wrestling entertainments?

- Yes No

Section 10 of 19

PROVISION OF LIVE MUSIC

Will you be providing live music?

- Yes No

Section 11 of 19

PROVISION OF RECORDED MUSIC

Will you be providing recorded music?

- Yes No

Section 12 of 19

PROVISION OF PERFORMANCES OF DANCE

Will you be providing performances of dance?

- Yes No

Section 13 of 19

PROVISION OF ANYTHING OF A SIMILAR DESCRIPTION TO LIVE MUSIC, RECORDED MUSIC OR PERFORMANCES OF DANCE

Will you be providing anything similar to live music, recorded music or performances of dance?

- Yes No

Continued from previous page...

Section 14 of 19

LATE NIGHT REFRESHMENT

Will you be providing late night refreshment?

Yes No

Section 15 of 19

SUPPLY OF ALCOHOL

Will you be selling or supplying alcohol?

Yes No

Standard Days And Timings

MONDAY

Start

End

Start

End

TUESDAY

Start

End

Start

End

WEDNESDAY

Start

End

Start

End

THURSDAY

Start

End

Start

End

FRIDAY

Start

End

Start

End

SATURDAY

Start

End

Start

End

SUNDAY

Start

End

Start

End

Give timings in 24 hour clock.
(e.g., 16:00) and only give details for the days
of the week when you intend the premises
to be used for the activity.

Continued from previous page...

Will the sale of alcohol be for consumption:

- On the premises Off the premises Both

If the sale of alcohol is for consumption on the premises select on, if the sale of alcohol is for consumption away from the premises select off. If the sale of alcohol is for consumption on the premises and away from the premises select both.

State any seasonal variations

For example (but not exclusively) where the activity will occur on additional days during the summer months.

Non-standard timings. Where the premises will be used for the supply of alcohol at different times from those listed in the column on the left, list below

For example (but not exclusively), where you wish the activity to go on longer on a particular day e.g. Christmas Eve.

State the name and details of the individual whom you wish to specify on the licence as premises supervisor

Name

First name

Family name

Enter the contact's address

Building number or name

Street

District

City or town

County or administrative area

Postcode

Country

Personal Licence number (if known)

Issuing licensing authority (if known)

Continued from previous page...

PROPOSED DESIGNATED PREMISES SUPERVISOR CONSENT

How will the consent form of the proposed designated premises supervisor be supplied to the authority?

- Electronically, by the proposed designated premises supervisor
- As an attachment to this application

Reference number for consent form (if known)

If the consent form is already submitted, ask the proposed designated premises supervisor for its 'system reference' or 'your reference'.

Section 16 of 19

ADULT ENTERTAINMENT

Highlight any adult entertainment or services, activities, or other entertainment or matters ancillary to the use of the premises that may give rise to concern in respect of children

Give information about anything intended to occur at the premises or ancillary to the use of the premises which may give rise to concern in respect of children, regardless of whether you intend children to have access to the premises, for example (but not exclusively) nudity or semi-nudity, films for restricted age groups etc gambling machines etc.

NONE

Section 17 of 19

HOURS PREMISES ARE OPEN TO THE PUBLIC

Standard Days And Timings

MONDAY

Start

End

Start

End

Give timings in 24 hour clock. (e.g., 16:00) and only give details for the days of the week when you intend the premises to be used for the activity.

TUESDAY

Start

End

Start

End

WEDNESDAY

Start

End

Start

End

THURSDAY

Start

End

Start

End

FRIDAY

Start

End

Start

End

Continued from previous page...

SATURDAY

Start	<input type="text" value="07:00"/>	End	<input type="text" value="21:00"/>
Start	<input type="text"/>	End	<input type="text"/>

SUNDAY

Start	<input type="text" value="07:00"/>	End	<input type="text" value="21:00"/>
Start	<input type="text"/>	End	<input type="text"/>

State any seasonal variations

For example (but not exclusively) where the activity will occur on additional days during the summer months.

Non standard timings. Where you intend to use the premises to be open to the members and guests at different times from those listed in the column on the left, list below

For example (but not exclusively), where you wish the activity to go on longer on a particular day e.g. Christmas Eve.

Section 18 of 19

LICENSING OBJECTIVES

Describe the steps you intend to take to promote the four licensing objectives:

a) General – all four licensing objectives (b,c,d,e)

List here steps you will take to promote all four licensing objectives together.

Adhere to Clerkenwell Licensees Charter.
Adhere to Islington's trading standards illicit alcohol and Tobacco-Business Guide
Full stock control so as any purchases can be traced back to original purchase in accordance with recommendations of Islington's Trading standards.
No beer, lager or Cider to be sold above 6.0%ABV
Staff training to be updated every four months and recorded.

b) The prevention of crime and disorder

- No alcoholic goods will ever be purchased or taken from persons calling to the shop.
- No spirits shall be purchased in a resealed box, without thorough checks being made to ensure it is legal to sell.
- The licensee will immediately report to Trading Standards any instance of a caller to the shop attempting to sell alcohol.
- Only alcoholic drinks which are detailed on invoices will be purchased or accepted as part of a 'free' offer. Invoices (or copies) for all alcoholic goods on the premises will be made available to officers from the council, police or HMRC upon

Continued from previous page...

request.

- A stock control system will be introduced, so that the licensee can quickly identify where and when alcoholic goods have been purchased.
- An ultra-violet light will be available at the premises for the purpose of checking the UK Duty Stamp on spirits as soon as practical after they have been purchased.
- If any spirits bought by the business have UK Duty Stamps that do not fluoresce under ultra-violet light, or are otherwise suspicious, the licensee shall identify the supplier to Islington Trading Standards as soon as possible.
- The licensee shall adopt 'Challenge 25', the Retail of Alcohol Standards Group's advice for off-licences, and promote it through the prominent display of posters.
- The licensee shall ensure that staff are trained about age restricted products and ensure that they sign to confirm that they have understood the training. The training shall include the assessment of age; making a challenge; acceptable proof of age; and recording refusals. The licensee shall keep records of training and instructions given to staff, detailing the areas covered, and make them available for inspection upon request by the licensing team, police or trading standards.
- The licensee shall put arrangements in place to ensure that before serving alcohol to persons they believe to be less than 25, staff ask to see accredited proof of age: that is, proof of age cards carrying the 'PASS' logo (and no others), a Passport, or UK Driving Licence bearing the photograph and date of birth of the bearer.

The licensee shall require staff to note any refusals to sell to young people in a refusals log. The refusals log shall be checked and signed monthly by the designated premises supervisor. The refusals log shall be made available for inspection upon request by the licensing team, police or trading standards.

- CCTV shall be installed, and operated and in agreement with the Police. Maintained means that the system will be re checked every two weeks to ensure that it is storing images correctly and a log kept and signed by a Supervisor to this effect. The system will provide an identifiable full head and shoulder image of everyone entering the premises and will operate in any light conditions within the premises. The system shall record in minimum of 12 frames per second, date and time stamped and will operate whilst the premises is open for licensable activities. The recordings will be kept for a minimum of 31 days and copies will be made available to an Authorised Officer or a Police Officer (subject to the Data Protection Act 1998) within 24hrs of any request. There will always be a member of staff on duty who can operate the system, to allow Officers to view recordings and if required by a Police Officer, provide a copy of images immediately.

c) Public safety

As above

d) The prevention of public nuisance

DAILY LITTER PATROL OF OUTSIDE THE PREMISES.

As above

e) The protection of children from harm

As above

Continued from previous page...

Section 19 of 19

PAYMENT DETAILS

This fee must be paid to the authority. If you complete the application online, you must pay it by debit or credit card.

Premises Licence Fees are determined by the non domestic rateable value of the premises.

To find out a premises non domestic rateable value go to the Valuation Office Agency site at http://www.voa.gov.uk/business_rates/index.htm

Band A - No RV to £4300	£100.00
Band B - £4301 to £33000	£190.00
Band C - £33001 to £87000	£315.00
Band D - £87001 to £125000	£450.00*
Band E - £125001 and over	£635.00*

*If the premises rateable value is in Bands D or E and the premises is primarily used for the consumption of alcohol on the premises then you are required to pay a higher fee

Band D - £87001 to £125000	£900.00
Band E - £125001 and over	£1,905.00

There is an exemption from the payment of fees in relation to the provision of regulated entertainment at church halls, chapel halls or premises of a similar nature, village halls, parish or community halls, or other premises of a similar nature. The costs associated with these licences will be met by central Government. If, however, the licence also authorises the use of the premises for the supply of alcohol or the provision of late night refreshment, a fee will be required.

Schools and sixth form colleges are exempt from the fees associated with the authorisation of regulated entertainment where the entertainment is provided by and at the school or college and for the purposes of the school or college.

If you operate a large event you are subject to ADDITIONAL fees based upon the number in attendance at any one time

Capacity 5000-9999	£1,000.00
Capacity 10000 -14999	£2,000.00
Capacity 15000-19999	£4,000.00
Capacity 20000-29999	£8,000.00
Capacity 30000-39999	£16,000.00
Capacity 40000-49999	£24,000.00
Capacity 50000-59999	£32,000.00
Capacity 60000-69999	£40,000.00
Capacity 70000-79999	£48,000.00
Capacity 80000-89999	£56,000.00
Capacity 90000 and over	£64,000.00

* Fee amount (£)

DECLARATION

I/we understand it is an offence, liable on conviction to a fine up to level 5 on the standard scale, under section 158 of the licensing act 2003, to make a false statement in or in connection with this application.

Ticking this box indicates you have read and understood the above declaration

This section should be completed by the applicant, unless you answered "Yes" to the question "Are you an agent acting on behalf of the applicant?"

Continued from previous page...

* Full name

ROBERT JORDAN PR RETAIL CONSULTANTS LTD

* Capacity

AGENT

* Date

21 / 10 / 2015
dd mm yyyy

Add another signatory

Once you're finished you need to do the following:

1. Save this form to your computer by clicking file/save as...

2. Go back to <https://www.gov.uk/apply-for-a-licence/premises-licence/islington/apply-1> to upload this file and continue with your application.

Don't forget to make sure you have all your supporting documentation to hand.

IT IS AN OFFENCE, LIABLE ON SUMMARY CONVICTION TO A FINE NOT EXCEEDING LEVEL 5 ON THE STANDARD SCALE, UNDER SECTION 158 OF THE LICENSING ACT 2003, TO MAKE A FALSE STATEMENT IN OR IN CONNECTION WITH THIS APPLICATION

OFFICE USE ONLY

Applicant reference number

islington-city news

Fee paid

Payment provider reference

ELMS Payment Reference

Payment status

Payment authorisation code

Payment authorisation date

Date and time submitted

Approval deadline

Error message

Is Digitally signed

< Previous 1 2 3 4 5 6 7 8 9 10 11 12 13 14 15 16 17 18 19 Next >

ENTRANCE AND
FIRE EXIT

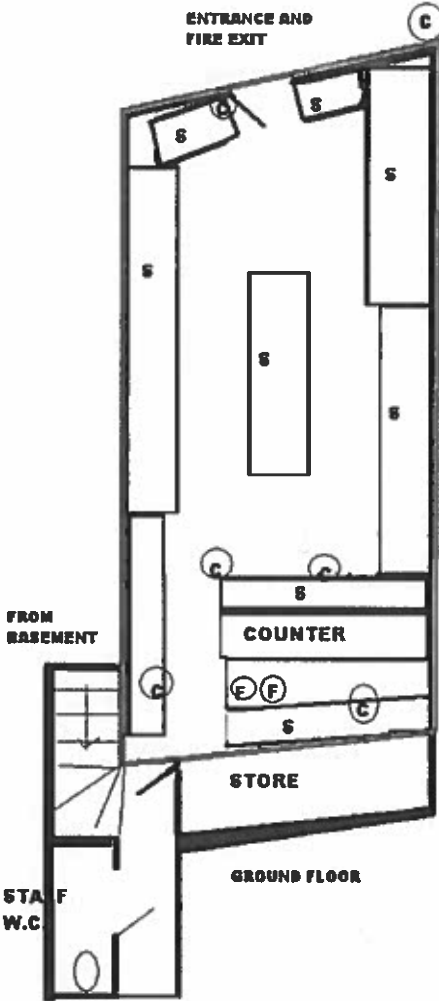

PREMISES: CITY NEWS, 4 EXMOUTH MARKET, LONDON, EC1R 4PX

(C) CCTV-EXISTING ADDITIONAL .TO BE ADDED AS PER OPERATING SCHEDULE.

(E) FIRE EXTINGUISHER

(S) DISPLAY SHELVING

WHOLE OF LICENSABLE AREA TO BE LICENSED FOR ALCOHOL DISPLAY

MAXIMUM 25% OF PREMISES FOR ALCOHOL DISPLAY

SCALE 1:100



LICENSABLE AREA

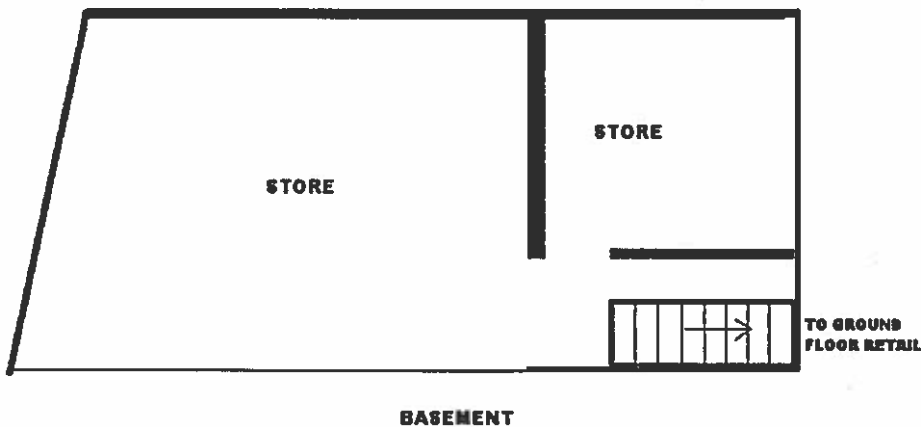

Licensing Authority Representation: Licensing Act 2003

Application: City News, 4 Exmouth Market, London EC1R 4PX

I am submitting a representation on behalf of the Licensing Authority with respect to the variation application for the above premises.

The grounds for the representation are:

- Public nuisance
- Crime and disorder

Licensing Policy Considerations

Licensing Policies 1 & 2
Licensing Policies 4 & 5
Licensing Policies 9

Location, cumulative impact and saturation
Off sales
Operating Schedules

Issues of Concern

1. The premises are located within the Clerkenwell Cumulative Impact policy area. The onus is on the applicant to demonstrate that these premises will not add to the cumulative impact. It is my opinion that the proposed application will add to the cumulative impact.
2. The licensing authority receives regular complaints from local residents and businesses about the impact of licensed businesses in Exmouth Market. Licensing officers regularly visit the area and have worked with local licensed operators to minimise the impact their businesses have on the local environment. There are two specific areas of concern:
 - i) The impact of street drinkers in the area, who typically arrive in the area early and consume alcohol on the street, in Exmouth Market and Spa Field Park. These street drinkers are associated with crime and disorder and public nuisance, such as littering, public urination and fighting.
 - ii) The impact of street drinking by persons arriving later in the day. These persons typically congregate in Exmouth Market in the vicinity of "on-licensed" premises. They are associated with issues of public nuisance, such as littering, noise nuisance and obstructing the public highway.
3. This application will undermine the licensing objectives and added to the cumulative impact principally because the proposed off sale hours will be attractive to both sets of street drinkers referred to above.

Recommendation

If the Licensing Committee is minded to grant the licence, I recommend that the licence be granted to allow off-sales between the following hours only: 11:00 to 20:00, Mondays to Sundays. I also recommend that the following additional conditions apply:

1. Outside of permitted hours for the sale of alcohol, all alcohol on display is to be secured behind locked shutters/screens/grills or secured behind locked cabinet doors.
2. There shall be no sales of spirits in vessels of 30cl or less.
3. Customers shall not be permitted to open or consume alcoholic products on the premises.

Janice Gibbons
Service Manager (Commercial and Licensing)
Janice.gibbons@islington.gov.uk
02 7527 3212

18 November 2015

Appendix 3

1. The licensee shall adhere to the Clerkenwell's Licensee Charter.
2. Staff training shall be updated every 4 months and recorded.

Additional Conditions proposed by Trading Standards and agreed by applicant

3. No alcoholic goods will ever be purchased or taken from persons calling to the shop.
4. No spirits shall be purchased in a resealed box, without thorough checks being made to ensure it is legal to sell.
5. The licensee will immediately report to Trading Standards any instance of a caller to the shop attempting to sell alcohol.
6. Only alcoholic drinks which are detailed on invoices will be purchased or accepted as part of a 'free' offer. Invoices (or copies) for all alcoholic goods on the premises will be made available to officers from the council, police or HMRC upon request.
7. A stock control system will be introduced, so that the licensee can quickly identify where and when alcoholic goods have been purchased.
8. An ultra-violet light will be available at the premises for the purpose of checking the UK Duty Stamp on spirits as soon as practical after they have been purchased.
9. If any spirits bought by the business have UK Duty Stamps that do not fluoresce under ultra-violet light, or are otherwise suspicious, the licensee shall identify the supplier to Islington Trading Standards as soon as possible.
10. The licensee shall adopt 'Challenge 25', the Retail of Alcohol Standards Group's advice for off-licences, and promote it through the prominent display of posters.
11. The licensee shall ensure that staff are trained on relevant matters including the conditions on the premises licence; age restricted products; and (if they are ever left in charge of the shop) the operation of the cctv system and how to deal with visits from authorised officers. The licensee shall keep records of training and instructions given to staff, detailing the areas covered, and make them available for inspection upon request by authorised officers. Staff shall sign to confirm that they have received and understood the training.
12. Age-restricted products training shall cover the following steps: the assessment of age; how and when to challenge for proof of age; acceptable proof of age and how to check it; and recording refusals.
13. The licensee shall put arrangements in place to ensure that before serving alcohol to persons they believe to be less than 25, staff ask to see accredited proof of age: that is, proof of age cards carrying the 'PASS' logo (and no others), a Passport, or UK Driving Licence bearing the photograph and date of birth of the bearer.
14. The licensee shall require staff to note any refusals to sell to young people in a refusals log. The refusals log shall be checked and signed monthly by the designated premises supervisor. The refusals log shall be made available for inspection upon request by the licensing team, police or trading standards.

Additional conditions proposed by Metropolitan Police and agreed by applicant

15. No super-strength beer, lagers, ciders or spirit mixtures of 6.0% ABV (alcohol by volume) or above shall be sold at the premises, except for premium beers or ciders supplied in glass bottles.
16. No more than 15% of the sales area shall be used at any one time for the sale, exposure for sale, or display of alcohol.
17. Signage to be prominently displayed of times alcohol available.
18. CCTV shall be installed, operated and maintained in agreement with the Police. Maintained means that the system will be regularly serviced (at least once a year) and checked every two weeks to ensure that it is storing images correctly and a log kept and signed by a supervisor to this effect. The system will provide identifiable full frontal head and shoulder image of everyone entering the premises and will

operate in any light conditions within the premises. The system will cover the full exterior of the premises and shall record in real time, date and time stamped and will operate whilst the premises is open for licensable activities. The recordings will be kept for a minimum of 31 days and copies will be made available to an Authorised officer or a police officer (subject to the Data protection Act 1998) within 24hrs of any request free of charge. There will always be a member of staff on duty who can operate the system, to allow officers to view recordings and if required by a Police Officer, provide a copy of images immediately free of charge to assist in the immediate investigation of offences. If the system malfunctions and will not be operating for longer than one day of business then Police must be informed.

Additional conditions proposed by Noise Service and agreed by applicant

19. No noise or vibration shall emanate from the premises so as to cause a nuisance to nearby properties. All mechanical installations associated with the business shall be regularly maintained and serviced to prevent public nuisance.

Additional conditions proposed by Licensing Service

20. Outside of permitted hours for the sale of alcohol, all alcohol on display is to be secured behind locked shutters/screens/grills or secured behind locked cabinet doors.
21. There shall be no sales of spirits in vessels of 30cl or less.
22. Customers shall not be permitted to open or consume alcoholic products on the premises.

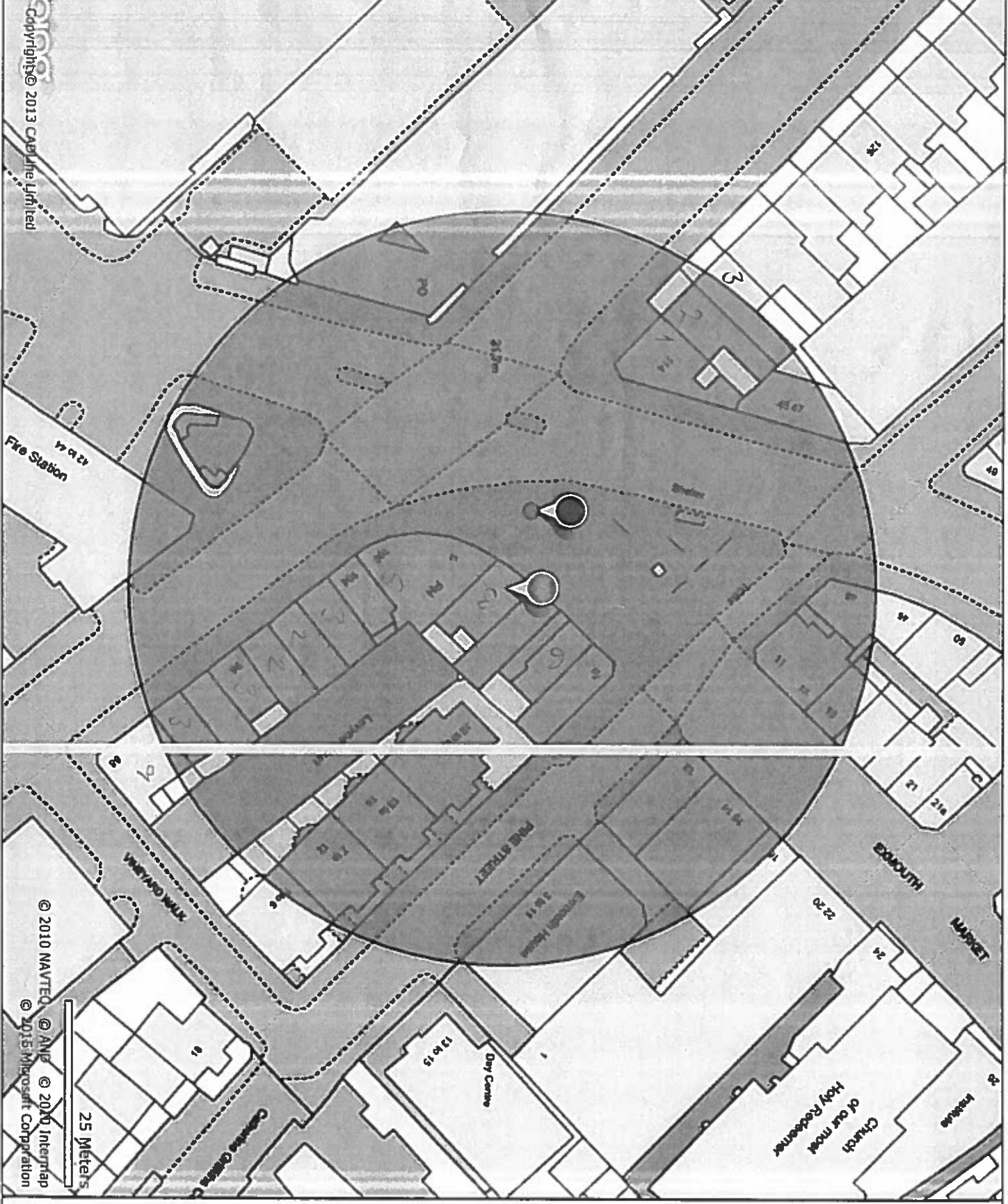

Title : 4 Exmouth Market

Islington Borough Boundary

24
36
16
20

Printed by :
RO RO

Printed at :
26-10-2015

ISUNGTON

25 Meters

© 2010 NAVTEQ © ANIP © 2010 Intermap
© 2015 Microsoft Corporation